

ESCALATOR HOPPER

Model **VHII-TK Type (Patent)**
Slide Track Included



VHII-TK
VHII-2TK
VHII-3TK
VHII-4TK

Motor Racing

- 8 minutes (AC Motor)
- Continuing (DC Motor)

Operating Temperature:

- -10°C ~ +60°C

Coin Capacity:

- approx. US 25¢ / 800 coins
- approx. US 1\$ / 700 coins
- approx. EUR 0.5\$ / 700 coins
- approx. EUR 1\$ / 800 coins
- approx. EUR 2\$ / 650 coins

Overall Height

- Model VHII-TK approx. 565.00 mm
- Model VHII-2TK approx. 910.00 mm
- Model VHII-3TK approx. 1255.00 mm
- Model VHII-4TK approx. 1595.00 mm

Pay-out Height

- Model VHII-TK approx. 520.00 mm
- Model VHII-2TK approx. 865.00 mm
- Model VHII-3TK approx. 1210.00 mm
- Model VHII-4TK approx. 1550.00 mm

Weight

- Model VHII-TK approx. 4.00 kg (AC Motor)
- Model VHII-TK approx. 3.55 kg (DC Motor)
- Model VHII-2TK approx. 4.51 kg (AC Motor)
- Model VHII-2TK approx. 4.00 kg (DC Motor)
- Model VHII-2TK approx. 4.00 kg (DC Motor)
- Model VHII-3TK approx. 5.30 kg (AC Motor)
- Model VHII-3TK approx. 4.80 kg (DC Motor)
- Model VHII-4TK approx. 5.76 kg (AC Motor)
- Model VHII-4TK approx. 5.12 kg (DC Motor)

TECHNICAL SPECIFICATIONS

Applicable Coin Sizes:

- Diameter: 22.00 - 26.00 mm
- Thickness: 1.60 - 3.20 mm

Dispensing Speed:

- US 25¢ 350 coins / minute approx.
- US 1\$ 280 coins / minute approx.
- US 25¢ 450 coins / minute approx. (High-Speed)
- US 1\$ 360 coins / minute approx. (High-Speed)

Dispensing speed may vary depending on motor gearbox deceleration ratio or coin specifications.

Counting Method:

- Optical reflective sensor

Motor Control:

- Dedicated Control Board

Motor (Voltage) Options:

- AC 110V、220V
(Thermal Protection & Instant Stop Device)
- DC 24V (Dedicated Controller 24VDC ±5%)

MAX. Current Consumption:

- AC 110V / 60Hz 4.85A、220V / 60Hz 2.68A
- DC 24V 2.90A、DC 24V 5.30A

SAFETY STANDARDS

Applicable Standards Standards File Number

EN 55014-1+A1 EB2G005

EN 61000-3-2+A1+A2

EN 61000-3-3

EN 55014-2

FCC RULES FD2G005

CISPR 22

FCC / ANSI C63.4

2002 / 95 / EC RoHS KA / 2006 / B1267

ACCESSORIES

- Optical reflective sensor: Model PS-1(Page 23)
The N.O. and N.C. built in the same Sensor.
The user through JUMP, be free to change.
- DC Control Pack: Model DH-2(Page 50~53)
Build in with Reversible Motor and Brakes
- Coin overflow and low level sensing by line

OPTIONS

- Computer Control Pack:
- Model DH-1 RS232(Page 44~45)
 - Model DH-1 USB(Page 44~45)

REMOVABLE BOWL

- One-touch removable bowl for quick maintenance and servicing

OTHER MODELS IN THIS SERIES

●VHII	Page 30~31
●VHII-TK	Page 32~34
●VHII-2TK	Page 32~34
●VHII-3TK	Page 32~34
●VHII-4TK	Page 32~34



1 Push forward here



2 Until most above



3 Finish removal

■ Dimensions
Unit: mm
Model VH_{II}-TK
AC Motor

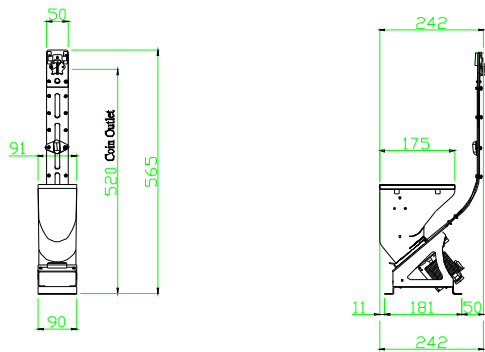

■ Dimensions
Unit: mm
Model VH_{II}-2TK
AC Motor

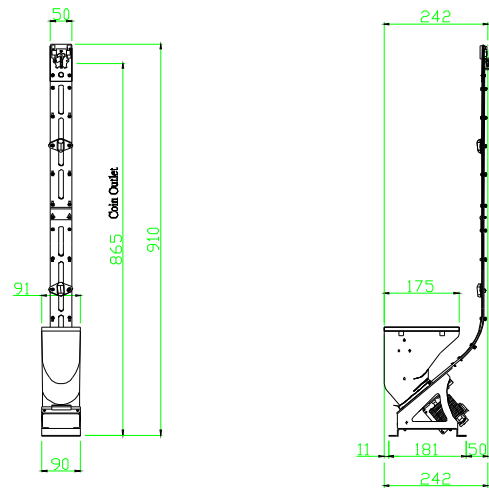

■ Dimensions
Unit: mm
Model VH_{II}-3TK
DC Motor

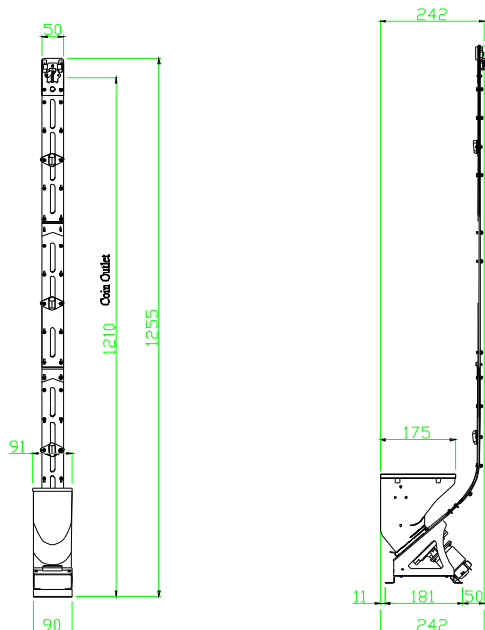

■ Dimensions Unit: mm VH_{II}-4TK DC Motor

